

Quick Reference Instructions

Express Results™ Oral Fluid Drug Test

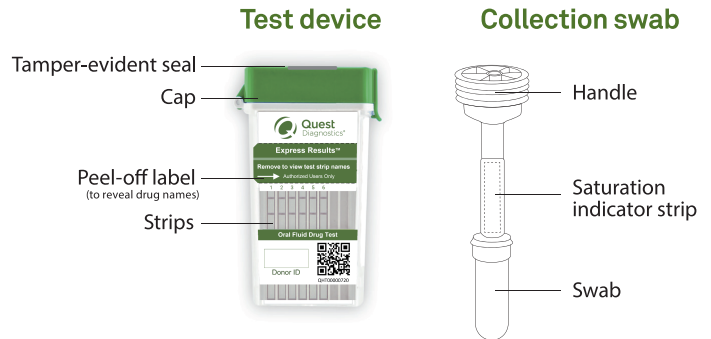

- Read the instructions carefully before starting the test.
- Before use, allow test kit to reach room temperature 15 °C - 30 °C/59 °F - 86 °F.
- Do not place anything in mouth at **least 10 minutes** before specimen collection.
- The oral fluid specimen must be collected using the collection swab provided with the test kit—no other collection devices can be used with this test device.
- Do not remove test materials from packaging until ready to begin test.



Materials required but not provided: Timer

1 Specimen collection

- Relax mouth, as this will aid in the collection.
- Remove the collection swab from packaging; ensure the swab does not touch anything, including hands.
- Insert the collection swab into mouth; ensure the collection swab remains horizontal during collection.
- **Important:** Do not bite, suck, or chew on the collection swab, as this could produce invalid results.

Start timer

- **For 3-7 minutes**, actively swab the cheeks, tongue, and gums while rotating the collection swab. Repeat until a red color appears on the saturation indicator strip.
- **After 7 minutes**, if the saturation indicator has not appeared, proceed to Step 2.

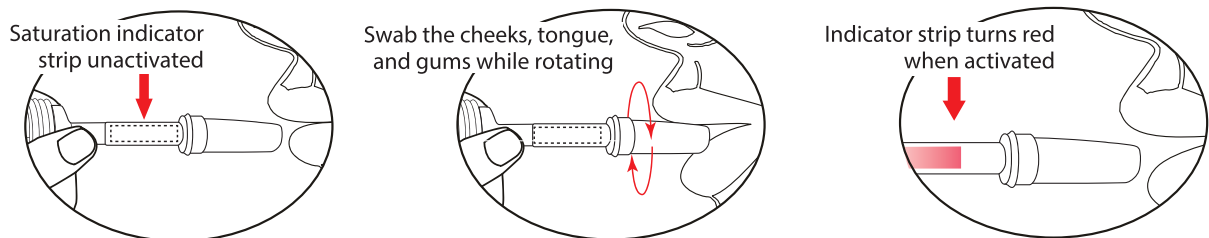

2 Insert collection swab into test device

- Remove test device from packaging and place upright on a clean, flat surface.
- **Slowly** insert the collection swab into the test device, swab first, until it reaches the bottom of the test device.
- Push the cap until it locks in place and is secure.
- Apply tamper-evident seal from cap down sides of device.
- **Important:** Keep test device upright while inserting collection swab.

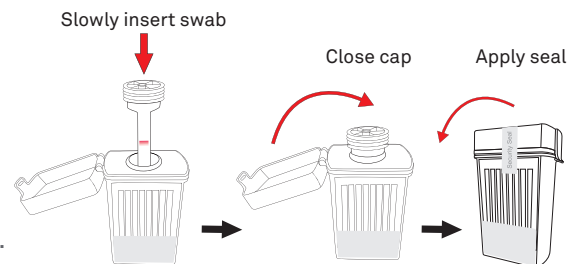

(Continue to step 3 on next page)

3 Allow test to process

Start Timer for 10 minutes

- Keep test device upright on a flat surface until the test is complete.
- Oral fluid will saturate test strips producing a dark color and then lighten throughout the processing time.
- **Important:** If any test strips do not develop, they are “invalid.” Inspect specimen volume at bottom of device. Refer to Notes and Troubleshooting.

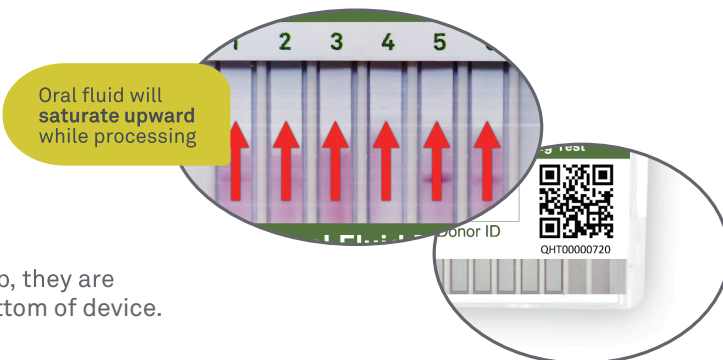

4 Read results

- Interpret results at 10 minutes.

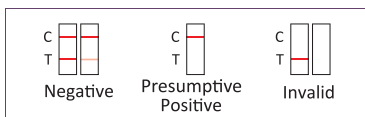

- **Note:** The shade of color in the test line region (T) may vary, but it should be considered negative whenever there is even a faint colored line.
- **Optional:** Test strip analyte information can be revealed by peeling away perforated strip on top label.

Notes and Troubleshooting:

- In the event that an invalid result occurs, ensure oral fluid reaches the bottom of the test strips. If oral fluid is present, try one of the following solutions:
 - Oral fluid that is too thick may have a harder time flowing through a strip. If a strip does not appear to be flowing and there is enough oral fluid, while ensuring that the device is kept upright carefully move the device back and forth across a flat, clean surface.
 - Oral fluid tends to form air bubbles that prevents its flow through the strip. Gently tap the device on a flat, clean surface to pop any air bubbles and allow proper flow of fluid through the strip.
 - If neither solution works, repeat procedure using a new test device and collection swab.

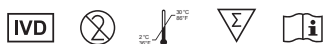

For Symbol Index, refer to the Package Insert.

QuestDiagnostics.com

Quest, Quest Diagnostics, any associated logos, and all associated Quest Diagnostics registered or unregistered trademarks are the property of Quest Diagnostics. All third-party marks—® and ™—are the property of their respective owners. © 2024 Quest Diagnostics Incorporated. All rights reserved. PP9183 05/2024